

PSLR-S

Guide Sottocassetto Ammortizzate, Estrazione Parziale, con Sgancio Rapido

Single-Extension Soft-Closing Under-Mounted Slides, with Quick-Release Handle

Specifiche/Specifications

Materiale/Material: Ferro zincato/Galvanized steel

Portata/Load rating: 25Kg (450 mm as standard)

Spessore/Thickness: 1.5x1.5mm

Durata/Cycling: over 50000 times

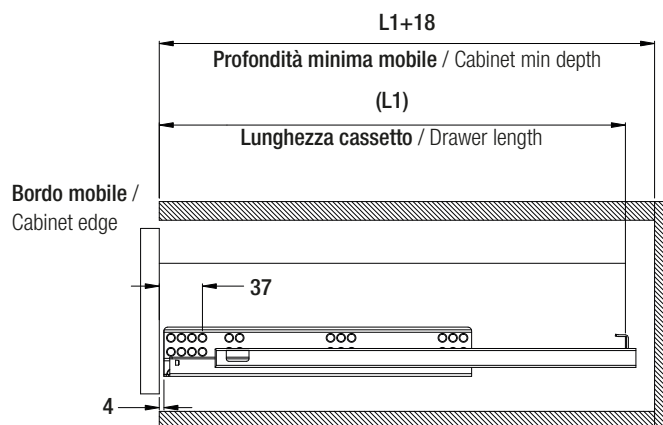
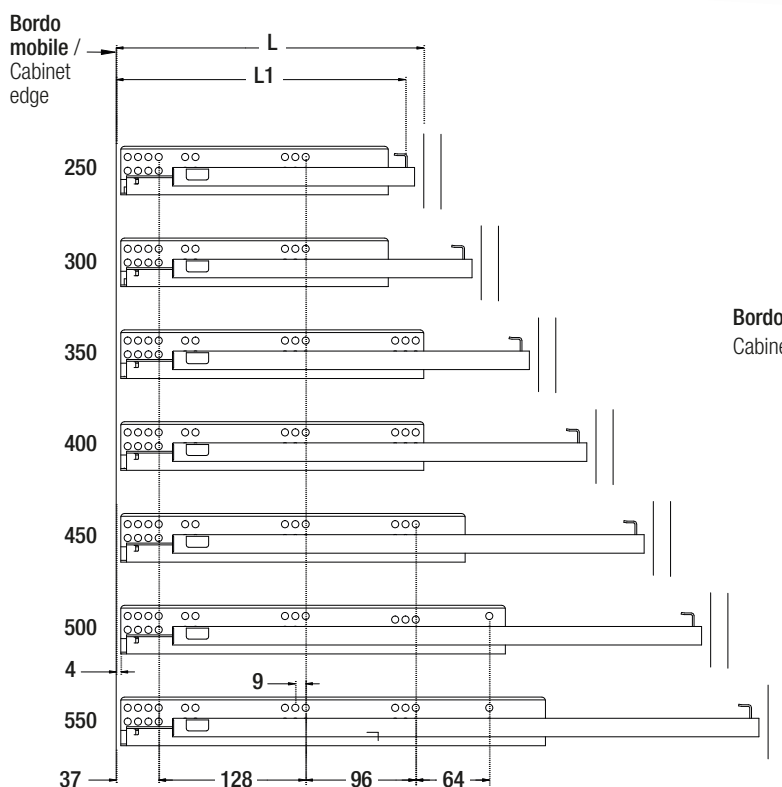

Cassetto standard / Standard drawer

Lunghezza guida Slide length	Lunghezza cassetto (L1) Drawer length (L1)	Profondità minima mobile (L) Cabinet min depth (L)	Coppie per scatola Sets per box
256mm	250mm	268mm	10
306mm	300mm	318mm	10
356mm	350mm	368mm	10
406mm	400mm	418mm	10
456mm	450mm	468mm	10
506mm	500mm	518mm	10
556mm	550mm	568mm	10

Spazio interno mobile Cabinet Inside Space

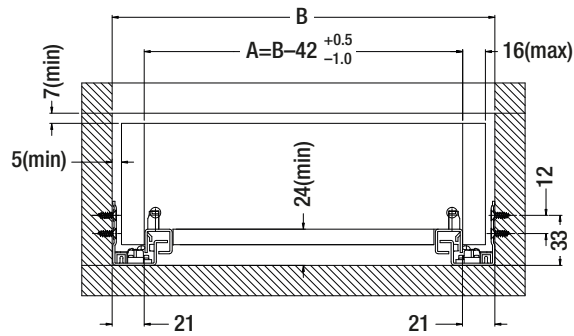

Dimensioni cassetto e schema foratura Drawer size and drilling diagram

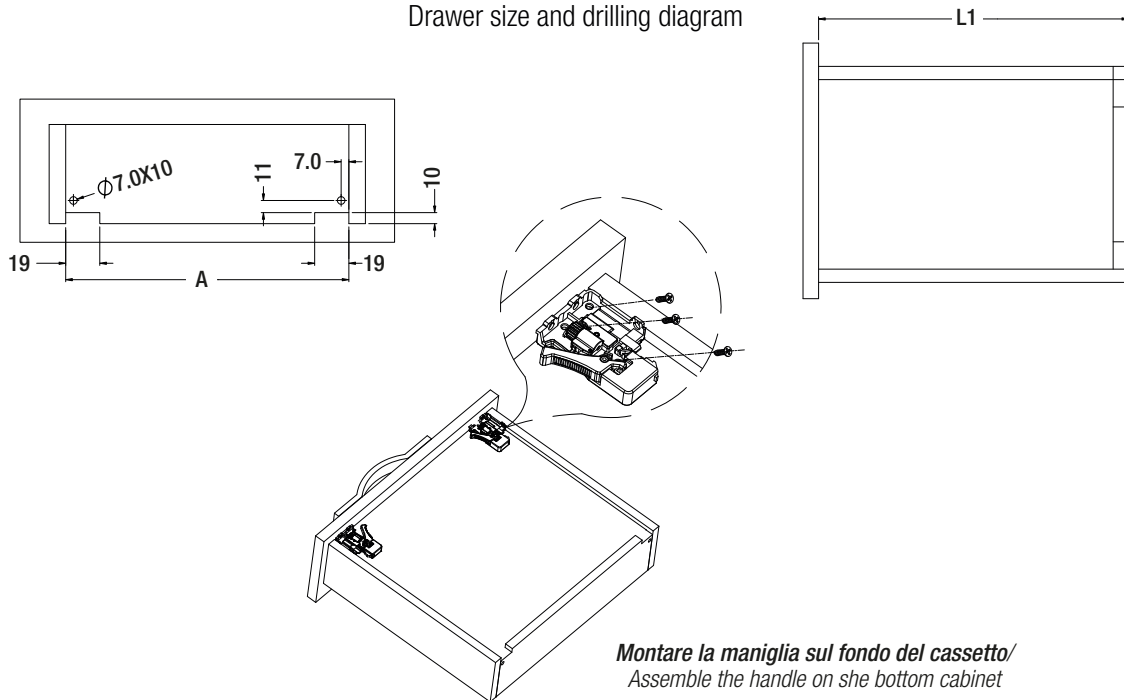

Montaggio Assembly

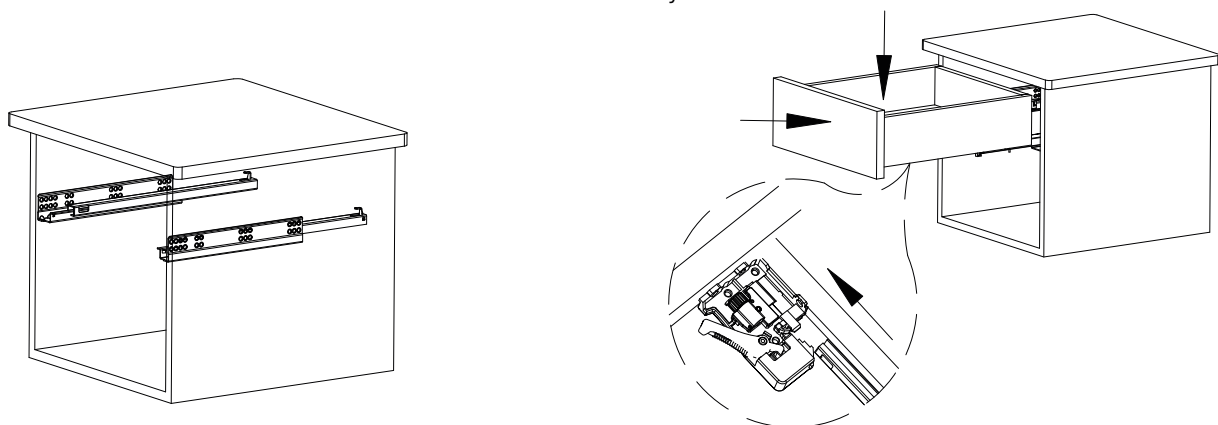

*Montare la guida sinistra e destra su entrambi i lati del mobile
/ Assemble the left and right slides on both sides of cabinet*

*Appoggiare il fondo del cassetto sulla guida e spingere il cassetto del mobile
/ Lay drawer bottom onto the slide then push the drawer into the cabinet*